



RHINE RIVER CRUISE TOUR

*Featuring Switzerland, France,
Germany & the Netherlands*

MAY 21 – JUNE 2, 2024

Flowing more than 760 miles from the Swiss Alps to the Netherlands and the North Sea, the Rhine River passes through a beautiful region charged with historical significance from the Roman era to our own. You will cruise from Switzerland through French and German territory to the Netherlands as you relax and delight in the changing landscapes, cultures, and cuisine along the way. Onboard the ship, enjoy a variety of enriching programs including fascinating lectures, cooking demonstrations, local cultural performances, and music by onboard musicians. Adding to the splendor of the river cruise, this tour offers three extra days at the beginning to explore some major cities of Switzerland and to learn about the importance of this region for Romans and the Reformation. We'll also have an extra day to explore Amsterdam at the end.

This is your invitation to travel along ancient waterways while relaxing in modern comfort.

Join Ken and Laurel Bratt on this adventure, along with friends from CALL and the Calvin Alumni Association!

REGISTER ONLINE NOW AT

bookings.wittetravel.com

use booking code **052124BRAT**

Tour Cost from Grand Rapids

Based on double occupancy

Other departure cities available upon request.

\$6,295 per person on the Haydn Deck

\$6,995 per person on the Strauss Deck

\$7,385 per person on the Mozart Deck

YOUR HOSTS:

Ken & Laurel Bratt

Ken Bratt is a retired professor of Classics at Calvin University who has led many student and adult groups to Greece and Italy. He and Laurel directed a Calvin Semester in Britain, and they have traveled with groups to Croatia, Germany, Greece, Italy, Switzerland, Alaska, the Canadian Rockies, the Pacific Northwest, and many of the national parks in the U.S.



They both have a passion for lifelong learning and love to share that learning by traveling with a group. They look forward to sharing this travel experience with you.

For more information, contact Ken
kdbratt@gmail.com
616-648-6407

YOUR CRUISE TOUR INCLUDES:

- **Roundtrip flights** from Grand Rapids. Other departure cities are available upon request.
- **Hotel accommodation in Geneva, Zurich, and Amsterdam.**
- **7-night Rhine River Cruise** with choice of stateroom.
- **Meals:** Adding to the value, all breakfasts and most lunches and dinners are included. Five lunches and one dinner will be independent. This gives you the joy of being served daily while allowing a few independent lunches and a night on the town in Geneva. Onboard meals include buffet breakfasts and lunches, five-course dinners, and late-night snacks.
- **Specialty dinners** include welcome and farewell cocktail receptions, welcome aboard dinner, and Captain's Gala Dinner.
- **Beverages on board the ship:** 24-hour coffee and tea station, coffee and tea after lunch and dinner, and free-flowing quality European red and white wine paired with each dinner.
- **Sightseeing:** Gain local insight with guided walking tours of Geneva, Zurich, and Amsterdam. For an additional cost, tailor your experience by participating in the cruise's shore excursions. A shore excursion to Heidelberg on May 27 is included in the price.
- **Audio headsets** for all excursions.
- **Four lectures by Ken, as well as onboard cruise entertainment** including talks, cooking demonstrations, and live music by onboard musicians.
- **Services of local guides and an experienced, multilingual cruise director.**
- **All port taxes and gratuities** for all tour services.
- **And more!**



❶ Zürich, Switzerland
❷ Reformation Monument,
Geneva, Switzerland
Cover Image: Burg Katz ruin on the
Rhine River

MAY/JUNE 2024

MAY 21, TUESDAY

Departure

The day of departure has arrived, and our adventure begins! We meet at the Grand Rapids Gerald R. Ford International Airport to check in for our transatlantic flights. (D-in flight)

MAY 22, WEDNESDAY

Arrive in Geneva, Switzerland

Good morning, and welcome to Europe! After going through passport control, we continue to the gate for our connecting flight to Geneva. Once we arrive there and claim our luggage, we'll meet our tour manager and driver. Before checking into our hotel, we'll have an orientation tour of the city in its beautiful lakeside setting. Fortified by the Romans in 58 B.C., today Geneva hosts over 250 international organizations and NGOs, including the International Red Cross and the European headquarters of the U.N. It was also a city of refuge for Protestants during the Reformation and is sometimes called "the Rome of Protestants." The Reformation came to Geneva through the work of William Farel, but John Calvin's career here is better known. Except for a brief period of exile in Strasbourg, Calvin lived and worked in Geneva from 1536 until his death in 1564. After check-in, there will be time for a short rest or a walk in the neighborhood before a welcome dinner at the hotel. To prepare for tomorrow's tour, Ken will introduce "Geneva, from Caesar to Calvin." (B-in flight, D)



MAY 23, THURSDAY

Geneva

Now that we've had a good night's rest, we're ready to begin exploring one of the world's great cities. We'll take a guided tour that includes City Hall and the Arsenal, with its mosaic of Julius Caesar in Geneva; the Gothic Cathédrale of St.-Pierre, where Calvin preached on Sundays and weekdays; L'Auditoire, where John Knox preached to English exiles and Calvin lectured on the Scriptures; and the Reformation Monument with its statues of the four great Reformers associated with Geneva: Calvin, Farel, Beza, and Knox. After lunch, enjoy a peaceful cruise on the beautiful Lac Léman (Lake Geneva), an arc-shaped lake that divides southern Switzerland from France and flows into the Rhône River. The rest of the afternoon is free for independent exploration or relaxation. We're on our own for dinner this evening. Ken and our tour manager can make suggestions for places to sample the local cuisine. (B)

MAY 24, FRIDAY

Bern & Zürich, Switzerland

Departing Geneva, we set out along the northern shore of Lake Geneva to Bern, the capital of Switzerland. The city's medieval core is preserved intact on a peninsula surrounded by the River Aare, and Bern is the only Swiss city to be honored by UNESCO as a World Heritage Site. We'll enjoy a guided tour of the Old Town with its Clock Tower, lovely old squares and fountains, and the splendid Cathedral of St. Vincent. In the afternoon we'll drive on toward Zürich, stopping at Uetliberg Mt. for a panoramic view over the city, Lake Zürich, the Limmat Valley, and the Alps. Then take an orientation tour of the city by coach. Zürich is the largest city in Switzerland and its financial, industrial, and commercial center. After we check in at the hotel and enjoy a group dinner, Ken will compare "Zwingli's Zürich and Calvin's Geneva." (B, D)

MAY 25, SATURDAY

Zürich, Augusta Raurica & Basel, Switzerland

In the morning we'll have a guided tour of central Zürich, including Zwingli's home and the Romanesque Grossmünster where he launched the Reformation in the German-speaking part of Switzerland. We'll also see the Fraumünster, an abbey closed during the Reformation, now famous for Marc Chagall's stained-glass windows. In the afternoon we'll drive toward Basel, making a stop at Augusta Raurica, an open-air museum featuring a Roman town founded on the Rhine in 27 B.C. On the coach, Ken will talk about "Romans on the Rhine" to introduce the many Roman sites along our route. In Basel, we'll board the new flagship *Amadeus Cara* for Lütner's Classical Rhine Cruise. We'll join our fellow travelers at a welcome reception followed by dinner. Our floating hotel departs late this afternoon. (B, D)



1

in 1518, but the region's Elector Frederick III also commissioned Ursinus & Olivianus to write the *Heidelberg Catechism*, published in 1563. We'll visit the Castle, the University (the oldest in Germany), and the Church of the Holy Spirit before returning to our ship. Late at night, the *Amadeus Cara* continues northward. (B, L, D)

OPTIONAL SHORE EXCURSION:

- Speyer walking tour & the Imperial Cathedral: €29 (approx. \$33) per person; 2.5 hours

MAY 28, TUESDAY
Rüdesheim & Koblenz, Germany

Two charming stops await us today. In the morning, we arrive in Rüdesheim, a town well known for its winemaking. You can explore the town on your own or on a guided tour with a stop to see a private collection of automated musical instruments at the Mechanical Music Cabinet Museum. Or you can choose to go farther afield to a local vineyard for a tasting of the wines of the area, finishing with a walk along the lively "Drosselgasse." The ship will depart at lunchtime to cruise the most picturesque section of the river, the Upper Middle Rhine Valley. The view of the myth-enshrouded Lorelei Rock is sure to be a highlight. In the afternoon we'll arrive in Koblenz (Roman Confluentes), at the junction of the Mosel River with the Rhine. Near here, Julius Caesar built the first bridge across the Rhine in 55 BC. You can end the day with a stroll through the pedestrian zone or join a guided walking tour and cable car ride to Ehrenbreitstein Fortress, high above the hill. (B, L, D)

OPTIONAL SHORE EXCURSIONS:

- Rüdesheim with Music Cabinet Museum: €33 (approx. \$40) per person; 2 hours
- Rüdesheim wine tasting and Drosselgasse: €50 (approx. \$56) per person; 2 hours
- Koblenz walking tour with Ehrenbreitstein Fortress: €52 (approx. \$58) per person; 3 hours



3

MAY 26, SUNDAY
Strasbourg, France

During the night, our ship left Switzerland and followed the Rhine into the Alsace region of France to Strasbourg (Roman Argentoratum). This is a city known not only for its romantic old town and Gothic Notre Dame Cathedral but also as the seat of the European Parliament and a culture that blends French and German elements. Strasbourg also figured prominently in the Reformation as a free Protestant city from 1529 on. Martin Bucer worked here, and Calvin spent his exile here from 1538 to 1541. Ken can direct you to the location where Calvin pastored a congregation of French refugees. Perhaps you'll wish to join a worship service in one of Strasbourg's many churches. You can explore the city independently or as part of an organized tour. Don't miss the monument to Gutenberg, whose invention of the printing press in the 1440s revolutionized the production of books and helped to spread the Reformation. In the afternoon you can take an optional tour of the Alsatian countryside with its quaint wine-growing villages. Late tonight, our ship departs for Germany. (B, L, D)

OPTIONAL SHORE EXCURSIONS:

- Strasbourg with canal boat tour: €76 (approx. \$85) per person; 4 hours
- Romantic Alsace and its wines: €78 (approx. \$87) per person; 4 hours

MAY 27, MONDAY
Speyer, Mannheim & Heidelberg, Germany

Before breakfast, we'll arrive in the Rhineland-Palatinate town of Speyer, which played a central role in the Holy Roman Empire during the Middle Ages. Here in 1529, the Protestant states first appealed to the imperial parliament against decisions of the Catholic majority. Our ship remains in Speyer until lunchtime, offering time to explore this historic destination on your own or with the guided tour. During lunch, our cruise will continue toward Mannheim, where it will dock for the remainder of the day. From Mannheim our CALL/CAA group will join the excursion to the nearby city of Heidelberg, which boasts a lovely Baroque old town and a dramatic Castle. Heidelberg was also an important center of the Reformation. Not only did Luther defend his teaching here

MAY 29, WEDNESDAY

Cochem, Germany

The vessel departs from Koblenz in the early morning hours and makes a detour along the Mosel River to the most romantic part of the valley and the little town of Cochem. The magnificent Reichsburg Castle overlooks the town and dominates the landscape. Down below, the town with its narrow streets, half-timbered houses, and numerous restaurants is an ideal setting to taste the wines of the region. Back on board, dinner is served as the journey continues toward Cologne. (B, L, D)

OPTIONAL SHORE EXCURSION:

- Cochem walking tour & Reichsburg Castle: €45 (approx. \$50) per person; 3 hours

MAY 30, THURSDAY

Cologne, Germany

The morning is dedicated to the fascinating cathedral city of Cologne (German Köln), which has over a million inhabitants. This city, too, was founded by the Romans as Colonia Agrippinensis in 13 AD, and its Römisch-Germanisches Museum preserves many objects from that era. Later it served as a capital of Roman Germania Inferior, and Constantine had a bridge over the Rhine built here in 310. Some highlights of the central city are its spectacular Gothic Cathedral (with relics of the three wise men), many Romanesque churches, and the Chocolate Museum. You can explore the city on your own or take the optional tour of the Gothic Old Town. After lunch, our vessel departs from Cologne for an afternoon of cruising. This evening, the Captain invites you to a festive Gala Dinner. (B, L, D)

OPTIONAL SHORE EXCURSION:

- Cologne walking tour & Kölsch beer tasting: €44 (approx. \$49) per person; 2.5 hours



MAY 31, FRIDAY

Amsterdam, the Netherlands

Before breakfast, we will cross another national border and arrive in the Dutch city of Amsterdam, the capital of the Netherlands. There are many things to do in this vibrant canal city. Please note that our CAA/CALL group will have a walking tour of the central city tomorrow. You may choose to explore the city by canal boat or venture to the town of Haarlem with its medieval center and Gothic Cathedral, just a short drive away. In the afternoon, you could join the excursion through the Waterland to the pretty villages of Volendam and Edam and a tasting of delicious Dutch cheese. After dinner, enjoy a rousing Shanty Choir performance to end the evening. The vessel remains in Amsterdam overnight. (B, L, D)

OPTIONAL SHORE EXCURSIONS:

- Amsterdam & iconic canal cruise: €68 (approx. \$76) per person; 4 hours
- Haarlem—art, history, and Dutch lifestyle: €46 (approx. \$52) per person; 4 hours
- A Dutch Trip to Waterland: €57 (approx. \$64) per person; 4.5 hours

JUNE 1, SATURDAY

Amsterdam

After breakfast, we'll disembark the *Amadeus Cara* and offload our luggage for later transport to our hotel. Then we'll enjoy a guided tour of central Amsterdam, walking through some of its famous neighborhoods and ending with a visit to the Nieuwe Kerk and the Royal Palace. Amsterdam was the center of the neo-Calvinist movement launched by Abraham Kuyper, a 19th-century sequel to the Reformation. After time for lunch, we have reservations for a visit to the world-famous art collection of the Rijksmuseum. The rest of the afternoon is unscheduled to allow for shopping or relaxing in this great city. We'll set a time to check into our hotel and enjoy a farewell dinner. Ken will end our trip with a short wrap-up of "Romans and Reformers on the Rhine." (B, D)

JUNE 2, SUNDAY

Return

All too soon it's time to say *au revoir / Auf Wiedersehen / tot ziens* to Europe. After taking a shuttle from the hotel to Schiphol Airport, we'll board our first flight home. Back in the U.S., we'll claim our luggage, clear customs, and recheck our bags before continuing to our connecting flight. We hope you've had a wonderful time sharing this adventure with new friends!

Shore excursions noted in this brochure may be purchased onboard the ship during the cruise. Witte will be offering three options of bundled excursion packages. Information and pricing for the bundled packages will be provided with your Welcome Aboard packet.

TOUR PACE



MODERATE – Activity levels vary from day to day. Sightseeing is often a brisk walk over distances of several miles on cobblestone streets and uneven ground.

- ① Strasbourg, France
- ② Amsterdam, the Netherlands
- ③ Heidelberg, Germany

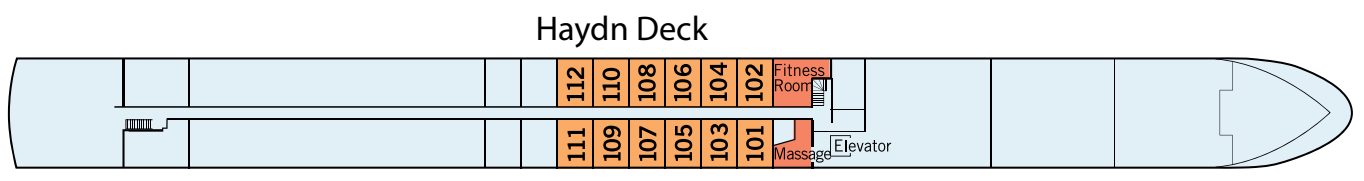
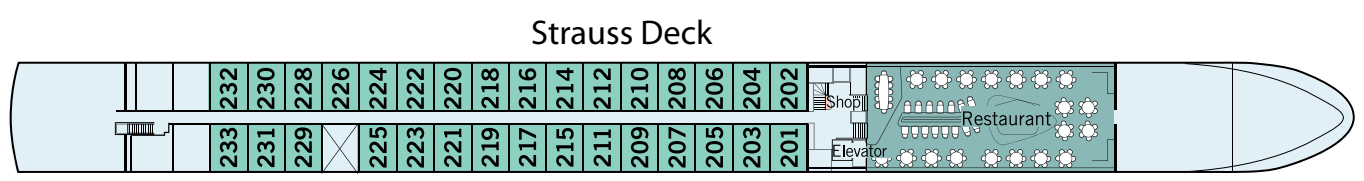
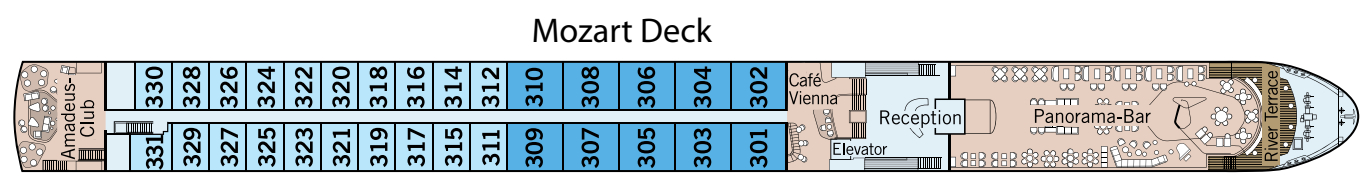
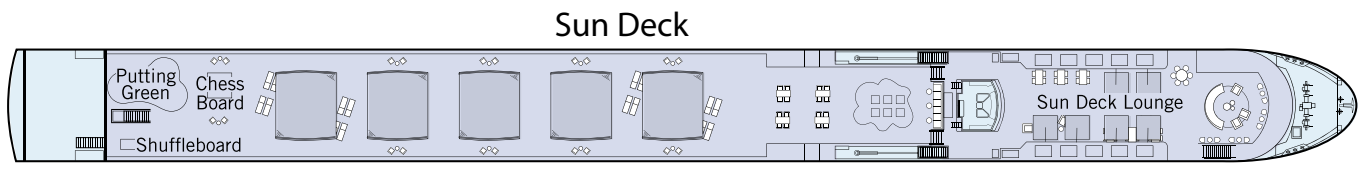
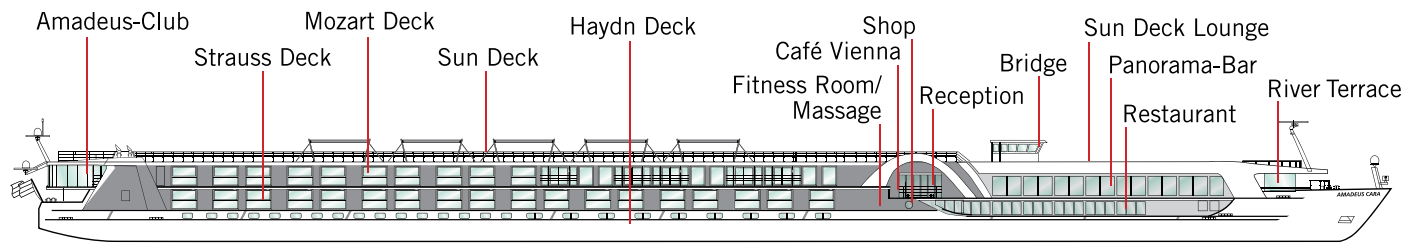

A-1	B-1	C-1
Mozart	Strauss	Haydn

Enjoy the Amadeus Cara

The 5-star-vessel *AMADEUS Cara*, which entered service in 2022, made once again the AMADEUS fleet one of the youngest and most modern river cruise fleets in Europe. The new ship offers space for 162 guests on a length of 135 meters. In addition to the Panorama Restaurant, the Panorama Bar and Lounge, the "Café Vienna", the Amadeus Club, the open-air "River Terrace" lounge and a fitness and massage room each, guests can expect an inviting, newly designed sun deck with a lower sun deck lounge. The very spacious interior concept is based on the multiple award-winning design of the AMADEUS Silver series, that allows for the highest level of living comfort.

STATEROOM AMENITIES

- Staterooms (17,5 m²/188 sq.ft.) on Strauss and Mozart Deck with drop-down panoramic windows
- Staterooms (16 m²/172 sq.ft.) on Haydn Deck with smaller panoramic windows (cannot be opened)
- Mini-Bar (all staterooms *except* on Haydn Deck)
- Walk-in wardrobe
- Choice of bed configuration: double or twin bed
- Flat-screen television
- Individual climate control
- Bathrooms with walk-in shower
- Hair dryer
- Direct dial telephone
- In-room safe

ONBOARD FACILITIES

- Panorama Restaurant
- Panorama Bar and Lounge
- Amadeus-Club
- "Café Vienna" with Viennese coffee specialties
- Outdoor glass-shielded "River Terrace"
- Sun Deck with Sun Deck Lounge, lounge chairs, shade awnings, golf putting green, giant chess board and shuffleboard
- Fitness Room, Massage Room
- Gift Shop
- Laundry Service
- Complimentary bicycles on board
- Wi-Fi available
- Elevator



Panorama Bar and Lounge



Panorama Restaurant

Stateroom on Strauss or Mozart Deck

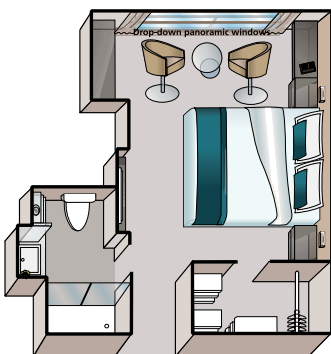

Stateroom on Strauss or Mozart Deck

Stateroom on Haydn Deck



REGISTER ONLINE NOW AT

bookings.wittetravel.com

use booking code **052124BRAT**

Tour Cost from Grand Rapids

Based on double occupancy

Other departure cities available upon request.

\$6,295 per person on the Haydn Deck

\$6,995 per person on the Strauss Deck

\$7,385 per person on the Mozart Deck



*Reserve
your spot
today!*

**IMPORTANT: PLEASE READ THESE TERMS AND CONDITIONS CAREFULLY BEFORE USING WITTE ASSOCIATES, INC.'S WEBSITE OR SERVICES.
TERMS AND CONDITIONS**

CONSENT TO TERMS AND CONDITIONS: Access to and use of the services of Witte Associates, Inc. dba Witte Travel & Tours ("Witte" and/or "our") and our website is subject to acceptance of these terms and conditions ("Terms and Conditions"). By accessing, using or obtaining any content, products, or services through our offices or through our website, you, the purchaser and/or traveler and/or participant ("you/your") agree to be bound by these terms. PLEASE READ THE TERMS AND CONDITIONS BEFORE USING THIS WEBSITE OR USING OUR SERVICES. If you do not accept all of these terms, then please do not use our services or our website. These terms and conditions govern the relationship between Witte and you. These terms restrict your rights and remedies and provide protection to Witte. These also include warranty disclaimers and liability exclusions. By using this website, you acknowledge and agree (a) this is a fair balance because this website is accessible by you conveniently and at no charge to access the website; and (b) if you do not agree or do not accept these Terms and Conditions, you can easily choose to not use this website or Witte's services. IF ANYTHING IS IN THESE TERMS AND CONDITIONS, INCLUDING WARRANTY DISCLAIMERS AND LIABILITY EXCLUSIONS, THAT YOU DISAGREE WITH OR ARE NOT WILLING TO BE BOUND BY, OR IF SOMETHING IS MISSING FROM THESE TERMS AND CONDITIONS THAT YOU CONSIDER ESSENTIAL, THEN YOU MUST NOT USE THIS WEBSITE OR OUR SERVICES. No alterations to these terms and conditions may be made by any Witte employee, representative or agent, unless in writing by an authorized officer of Witte.

General Data Protection Policy. We collect personal data, including, but not limited to legal name, gender, date of birth, passport information, dietary needs, and mobility concerns for the purpose of making travel arrangements on your behalf. We share this information with suppliers as it relates to the operation of your trip/tour. By signing the registration form/agreeing to the terms in TRIP, you agree to sharing your personal data for the purpose of making travel agreements on your behalf.

The cost of your tour includes:

Air transportation from Grand Rapids to Geneva and Amsterdam returning to Grand Rapids with any regularly scheduled air carrier, based on a nonrefundable/nonchangeable fare, which requires a minimum of 10 passengers traveling round trip together. The identity of the carrier, which may include the carrier's code-share partner, will be assigned and disclosed in your final documents. Tickets are issued 45 days prior to departure. All current airlines taxes, security fees and fuel surcharges are included. Note that these items cannot be guaranteed until tickets are issued.

Secure flight information. The requirement to collect date of birth, gender, and full name are federally mandated by the Transportation Security Administration's (TSA) Secure Flight Program. While disclosure of this information is voluntary, if it is not provided, participants may be denied boarding. TSA's privacy policy, as well as additional details, can be found at tsa.gov using the keywords Secure Flight. Witte takes all reasonable steps to safeguard the privacy of all information collected from its clients.

Frequent flyer points are not guaranteed in connection with group airfares. Some airlines may limit group airfare credits to 25% to 50% of the frequent flyer points that apply to individuals while others do not offer any credits for group airfares.

Hazardous Materials. Federal law forbids the carriage of hazardous materials aboard aircraft in your luggage or on your person. A violation can result in five years' imprisonment and penalties of \$250,000 or more (49 U.S.C. 5124). Hazardous materials include explosives, compressed gases, flammable liquids and solids, oxidizers, poisons, corrosives and radioactive materials. For more information, examples and special exceptions, visit: <http://www.tsa.gov/traveler-information/prohibited-items>.

Surface transportation. For complete itinerary by deluxe, air-conditioned motorcoach for transfers, excursions, and travel between cities, and by river cruise ship. Because motorcoach travel is restricted in many European cities, sightseeing is often done on foot or via public transportation.

Accommodations for four nights in first-class hotels in Geneva, Zurich, and Amsterdam and seven nights on board the *MS Amadeus Cara*. On the ship, all cabins are outside facing and have beds that can be linked together or set up separately. **Single occupancy:** The single supplement charge is high, and based on cabin type and availability. If you register alone but want a roommate, we will do our best to assign one. If a single room/cabin must be assigned to any member of the group for any reason, even if it is at the last minute or while on tour, we will need to charge the single supplement. Changes in rooming arrangements requested by the participant 45 or fewer days prior to departure may result in additional charges.

Meals as indicated in the itinerary. During the land portion of the tour, dinners do not include beverages. On board the ship, beverages are included.

Tour Personnel. Ken & Laurel are your hosts. English-speaking European tour guides will accompany the group from arrival in Geneva until boarding the ship in Basel, and for the last day in Amsterdam. An English-speaking cruise director will be on board the ship, along with local guides for shore excursions.

Sightseeing and admission fees in accordance with the itinerary.

Tipping and taxes are included for all services, including tips for pre- and post-cruise tour guides and drivers, as well as for cruise personnel on board the ship.

The tour cost does not include passports, airline luggage fees if charged, portage of luggage, optional travel protection plan including luggage and trip cancellation coverage, optional excursions, independent meals, and any other items not mentioned as included.

Insecticide Disclosure. Some countries require that aircraft be treated with insecticides prior to flight or while occupied. For a list of the countries with insecticide requirements, go to <http://airconsumer.dot.gov/spray.htm>.

Optional travel protection. Witte recommends that you purchase a travel protection plan. For your convenience, Witte Travel offers a travel protection plan designed by Travelix Insurance Services. This travel protection can be purchased at any time prior to making the final payment for your tour. **To be eligible for the waiver of pre-existing medical condition exclusion, the protection plan must be purchased within 15 days from the time you make your initial trip deposit, provided you are medically fit to travel at the time of purchase and full trip cost is insured. The pre-existing medical exclusion applies to you, your traveling companion, business partner and traveling or non-traveling family member. For all traveling companions to benefit from the pre-existing condition waiver, each must enroll in travel protection within 15 days of initial deposit and meet qualifications for the pre-existing condition waiver.** The plan cost for the travel protection plan that applies to your tour will be noted in your brochure and on the registration form. It may be necessary to increase the trip cost insured on the travel protection plan if you purchase additional services and/or upgrade any arrangements. This could increase the plan cost of the travel protection plan. This travel protection plan is refundable during the 15 day (30 day for IN residents) review period following the purchase of the plan; as long as you have not departed on your trip or filed a claim.

Schedule of Coverages	Maximum Coverage Amount (up to the limits shown below)
Trip Cancellation	100% of Insured Trip Cost
Trip Interruption	150% of Insured Trip Cost
Trip Delay	\$.750 (\$150/day)
Missed Cruise Connection	\$750
Baggage & Personal Effects	\$2,000
Baggage Delay	\$250
Equipment Delay	\$200
Emergency Medical & Dental Expense	\$50,000(\$500 dental sublimit)
Emergency Evacuation and Repatriation	\$250,000
Accidental Death & Dismemberment	\$25,000
24 Hour Travel Assistance & Concierge Services*	Included

*Travel Assistance & Concierge Services are provided by the designated provider listed in the Policy. Maximum trip length allowed is 90 days. Coverage and rates may vary by state. Rates are subject to change. The product descriptions provided here are only brief summaries and may be changed without notice. The

full coverage terms and details, including limitations and exclusions, are contained in the insurance policy. Prior to purchasing, you may view/download the Policy based on your state of residence at: <http://policy.travelixinsurance.com/335A-1217>. Travel Insurance is underwritten by, Berkshire Hathaway Specialty Insurance Company; NAIC #22276. ZKN

The purchase of this product is not required in order to purchase any other travel product or service. Your travel retailer might not be licensed to sell travel insurance and will only be able to provide general information about the product. An unlicensed travel retailer may not answer questions about the terms and conditions of the insurance offered and may not evaluate the adequacy of your existing insurance coverage. The products being offered provide insurance coverage that only applies during your covered trip. You may have insurance coverage from other sources that provide similar benefits but may be subject to different restrictions depending upon the coverage. You may wish to compare the terms of the travel policy offered through Travelix with any existing life, health, home and automobile insurance policies you may have. If you have questions about your coverage under your existing insurance policies, contact your insurer or insurance agent or broker.

Documentation: Passports, Visas, and Travel Consent for Minors. All U.S. citizens are required to have a valid passport book to travel internationally. If you already have a passport book, check its expiration date now since the countries visited on this tour require passports to be valid for at least six months beyond the traveler's intended return date. If your passport is due to expire earlier, you will need to obtain a new one. **If you do not have a passport book or need a new one, apply as soon as possible as processing times can take up to six months.** If you plan to visit other countries on your own, contact Witte for any special requirements. All non-U.S. citizens should contact Witte for their special requirements. We will check the requirements for non-U.S. citizens at the time they register and again approximately 45 days prior to departure. Witte is not responsible for any changes in requirements for non-U.S. citizens that occur after our final check.

When travelling domestically or internationally, the U.S. Transportation Security Administration (TSA) and U.S. Department of Homeland Security (DHS) advise that everyone carry at least two forms of acceptable identification in order to board a flight found <http://www.tsa.gov/traveler-information/acceptable-ids>. Examples: DHS-designated enhanced driver's license, U.S. Passport, a foreign government passport. The name, date of birth and gender that appears on the identification card must exactly match the same data listed on airline ticket(s) and booking records

Minor children traveling internationally without both parents are strongly encouraged to carry a notarized note signed by both parents stating that they have permission to travel without one or both of them. It has become increasingly necessary to possess such a note, and will save time if questions arise departing from the U.S. or to exit a foreign country. In order to download a sample minor consent form go to: <https://www.us-passport-service-guide.com/minor-travel-consent-form.html>The sample form is a guide only. Parents who share custody of their children should carry copies of the legal custody documents. Important note: Parents are responsible to contact the embassy of the country or countries the minor child will be visiting to confirm all travel entry and exit requirements, which may include obtaining additional notarized documentation.

HEALTH DOCUMENTATION REQUIREMENTS. You are responsible to make absolutely certain to have the proper immunizations and required documentation of such immunizations before travel. Witte shall not assume responsibility for the accuracy of health requirements or vaccination documentation prior to departure or upon landing at the final destination. See your health practitioner for advice. Prior to travel, required inoculations, if any, must be recorded by your health practitioner on a valid vaccination certificate, and you must carry for proof of inoculation where required. If you are concerned about taking any medications or receiving certain inoculations, and adequate timing of such inoculations relative to your travel booking, consult your health practitioner BEFORE booking. Check the U.S. State Department websites <http://travel.state.gov> for relevant information relating to travel to specific destinations, the USA Centers for Disease Control <http://wwwnc.cdc.gov/travel/destinations/list/> and the World Health Organization <http://www.who.int/en/relating-to-health-issues>.

Luggage allowance. You may take one suitcase with a maximum size of 62 linear inches (height plus width plus depth) and weight of 50 lbs. You may also carry a purse, a camera and one piece of hand luggage with a maximum size of 45 linear inches and weight of 15 lbs. These size and weight restrictions conform to most airlines' requirements. Hand luggage does not fit in the overhead bins on the motorcoach. There may be room for it in the storage compartment under the coach or by an empty seat on board. If not, it will need to be placed on the floor in front of your feet.

Tour cost. The tour cost is based on a group of 32 passengers and current tariffs for air and land arrangements.

Please note that these travel arrangements are subject to possible price increases due to additional charges imposed by a supplier or government. You may be charged additional sums by Witte to offset increased fees, fuel surcharges, taxes, fluctuations in foreign exchange markets, and/or changes in group size. Before passing on an increase, Witte will use its best efforts to minimize the amount. If it is necessary to increase the tour cost, participants will be advised at final billing and provided with a summary of the contributing factors. Your signature on the registration form indicates consent to any post-purchase price increases.

Reservations and payments. To make reservations on this tour, visit bookings.wittetravel.com to register online. Reservations cannot be accepted over the telephone. Payments are due as follows:
 Deposit of \$600 per person with Registration Form by November 15, 2023. Reservations may be accepted after this date, provided space is still available.
 Payment of \$2,000 per person by January 15, 2024.
 Payment of \$2,000 per person by March 15, 2024.
 Balance due on receipt of final invoice sent approximately 30 days prior to departure
 If you are registering for the tour after one of the above payment dates, increase your deposit amount accordingly so your account will be up to date. Please note that checks returned due to insufficient funds are subject to a \$30 service fee.

Credit card payments. Visa, MasterCard, Discover or American Express credit cards are accepted for the deposit. The deposit charge is processed shortly after receipt of your registration form.

Cancellations and refunds. Witte must receive notice of cancellation in writing. Penalties are per person and will be based on the date of receipt, as follows:

More than 120 days before departure	\$400
Between 120 and 91 days before departure	\$.1,000
Between 90 and 61 days before departure	\$.3,000
Between 60 and 31 days before departure	\$.4,000
30 or fewer days before departure	No refund

The service fee noted under "Special Flight Arrangements" and the nonrefundable portion of any special arrangements, or any other non-refundable arrangements made on behalf of the canceling participant, are also added to the above penalties. Allow four to six weeks for processing of refunds. Note that payments made by check are refunded by check to the person or organization that made the payments, and payments charged to a credit card are credited back to the same credit card.

Membership/Passenger's Responsibility. You acknowledge Witte is responsible for a comfortable and respectful atmosphere that protects the health of all travelers, creating a positive tour experience. This requires commitment from every individual on the tour to assume personal responsibility for protecting their own health and wellbeing, as well as the health and wellbeing of other travelers and tour personnel. You pledge to follow local and state laws as well as tour and sightseeing requirements related to any community health concern. If you refuse to comply with these rules of conduct, you understand that Witte Travel & 052124BRAT_TERMS

Tours reserves the right to remove you from the trip and you are responsible for any associated expenses. Witte reserves the right to accept or reject any person as a member of the tour and to expel from the tour any participant whose conduct or condition is incompatible with the interest of the group.

Land-only participants. If you wish to make your own flight arrangements, contact Witte for the land-only cost at least 90 days prior to departure. Participants who make their own flight arrangements are strongly encouraged to coordinate their flight schedules with the group's flight schedule and to use the same airports. The group's airport transfers on the arrival and return days will be timed to the group's flight schedule. Land-only participants may need to arrange for their own airport transfers. Contact Witte for information and costs on options for private transfers. Witte cannot be responsible for any inconveniences to land-only participants resulting from changes in the group's flight schedule. Participants who change their status to land-only less than 90 days prior to departure may be subject to penalties imposed by the airlines.

Domestic flight connections. Note on your registration form if you would like to fly to and from the international departure city. You will be contacted with schedule options and costs. Witte must receive requests for connecting flights at least 45 days prior to departure.

Special flight arrangements. Note on your registration form if you would like to extend your stay and/or depart from and/or return to another city. The number of passengers who can deviate from the group's flight schedule is restricted. You will be contacted to let you know if the arrangements you requested are possible and to advise you of schedule options and costs. Upon confirmation of your special arrangements, a nonrefundable service fee of \$75 per person will be added to your account along with any additional air or land costs that may apply. In the event of cancellation, the service fee and any nonrefundable portion of special air or land arrangements made for you will be added to the penalties noted under "Cancellations and Refunds." Witte must receive requests for special flight arrangements at least 45 days prior to departure.

Special meal requests and food allergies. Note special meal requests and food allergies on your registration form. Witte cannot be responsible if special requests are not met but we will pass them on to the airlines, hotels and restaurants. If you have dietary restrictions or food allergies, be sure to carry your medications with you at all times. Also, discuss your special needs with your tour personnel and ask the wait staff about the foods you are served.

Mobility Concerns. Sightseeing on Witte tours almost always includes walking. Visits to historical places often mean climbing stairs and walking on uneven surfaces or cobblestones. The Americans with Disabilities Act ("ADA") is only applicable within the U.S., and facilities for disabled individuals are limited outside its borders. A qualified and physically able companion must accompany travelers who need such assistance. Motorized scooters and wheelchairs are unsuitable for many trips. Transportation services, including many tour motor coaches, are not equipped with wheelchair ramps. Handicap accessibility is not always available. Witte tour personnel are not able to provide attendant services.

Consult your physician if you have any concerns about your ability to participate.

Time away from the tour. Advise Witte in writing at least 45 days before departure if you plan to spend some time away from the tour. Wherever possible, you will be credited for missed hotel nights.

Final tour documents—including itinerary, hotel list, passenger list, flight schedules with departure instructions, and luggage tags—are sent about 10 days prior to departure. Flight tickets are usually made available at the airport at check-in.

Limitations of Responsibility and Disclosure. The trip outlined herein has been contracted with Lüftner Cruises. Witte acts solely as a booking agent for disclosed principal supplier hotels, airlines, air charters, bus companies, ground transportation, cruise lines, boat purveyors or owners, and other independent contractors providing accommodations, transportation, and/or other services ("supplier(s)"), and is not the source or provider of the travel services. Each of these supplier companies is an independent entity with its own management, and is not subject to the control of Witte. Participant is advised that the suppliers whose names appear in travel documentation are those actually responsible for providing the travel services purchased, and consents to the use of those suppliers, and understands and agrees each supplier's Terms and Conditions are contained in printed form and are set forth on their respective Web sites, which govern the transaction. All bookings are accepted by Witte as agent for the travel suppliers on your itinerary. The transportation, accommodations and other services provided by the identified sea, ground, and air operator suppliers offered are subject to the terms and conditions contained in the tickets, exchange orders or vouchers issued by them and/or their suppliers, including Terms and Conditions on their respective Web sites.

BECAUSE WITTE ACTS AS AGENT FOR DISCLOSED PRINCIPAL SUPPLIERS, AND DOES NOT HAVE THE RIGHT TO CONTROL THE OPERATIONS OF SUCH INDEPENDENT OPERATORS AND SUPPLIERS, YOU AGREE WITTE IS NOT LIABLE FOR ANY PERSONAL INJURY OR PROPERTY DAMAGE, WHICH MAY ARISE OUT OF THESE SERVICES. WITTE HEREBY DISCLAIMS ANY LIABILITY WHETHER BASED ON CONTRACT, TORT, STRICT LIABILITY OR OTHERWISE, INCLUDING WITHOUT LIMITATION LIABILITY FOR ANY DIRECT, PUNITIVE, SPECIAL CONSEQUENTIAL, INCIDENTAL OR INDIRECT DAMAGES, IN CONNECTION WITH THE GOODS OR SERVICES PROVIDED BY ANY PRINCIPAL SUPPLIER BOOKING THROUGH WITTE'S OFFICE OR THROUGH THEIR WEB SITE, INCLUDING WITHOUT LIMITATION LIABILITY FOR ANY ACT, ERROR, OMISSION, INJURY, LOSS, ACCIDENT, DELAY OR IRREGULARITY WHICH MAY BE INCURRED THROUGH THE FAULT, NEGLIGENCE, WILFUL ACTS, OMISSIONS OR OTHERWISE OF SUCH SUPPLIER, OR OF ANY SUPPLIER OR THEIR RESPECTIVE EMPLOYEES, AGENTS, SERVANTS, OR REPRESENTATIVES, INCLUDING, WITHOUT LIMITATION, THEIR FAILURE TO DELIVER OR THEIR PARTIAL OR INADEQUATE DELIVERY OF SERVICES, FUEL INCREASES, AND OTHER MATTERS OUTSIDE OF WITTE CONTROL, AND PARTICIPANT HEREBY EXONERATES WITTE FROM ANY LIABILITY WITH RESPECT TO THE SAME.

Witte, its agents, sponsors, organizers and employees shall not be responsible for any injury, loss, damage, accident, delay, irregularity or expense arising from strikes, weather, sickness, acts of war or terrorism, governmental restrictions or regulations or from any act or omission on the part of any individual or company furnishing transportation, accommodations or any other services to the tour participants; absent gross negligence, Witte shall not be responsible for any injuries, death, damages, loss or delay by any means of transportation or by reason of any event beyond its actual control.

Weather conditions, including but not limited to the presence or absence of snow, sunshine, and rainfall are not guaranteed to occur or not occur, and are outside of Witte's control. Volcanic eruptions, ash clouds, and wind may be characterized as an adverse weather condition or a natural disaster by suppliers and your travel insurance company, which is beyond the control of Witte.

Witte shall not assume any responsibility for any air and/or ground schedule changes.

Witte reserves the right to make alterations in the itinerary as it deems necessary.

Force Majeure. "Force Majeure" means, in relation to Witte, any circumstances beyond the reasonable control of Witte, (including, but without limitation, acts of God, explosion, tidal waves and flood, tempest, forceful wind, earthquakes, fire or accident, hostilities, war or threat of war declared or undeclared, acts or threats of terrorism, sabotage, insurrection, riots, strikes, civil disturbance, requisition, epidemic, sickness, quarantine, government intervention, invasion, act of foreign enemies, mobilization, embargo, weather conditions, defects in machinery and vehicles, delay, wildlife, contamination by radio-activity from any nuclear fuel or from any nuclear waste, or other untoward occurrences).

Witte shall not be deemed to be in breach of these terms and conditions or otherwise be liable to you, by reason of delay in performance, or by non-performance, of any of its obligations hereunder to the extent that any such delay or non-performance is due to any Force Majeure.

If Witte, and/or any of its travel suppliers, are affected by Force Majeure, they shall be entitled to, and may in their sole and absolute discretion, vary or cancel any itinerary or arrangement in relation to the trip. Payment of any refund by Witte to you as a result of the non-performance of any obligations due to Force Majeure shall remain in its sole and absolute discretion, although Witte shall use its reasonable efforts to reimburse you where possible. However, Witte shall be entitled to deduct from any refund recoverable the reasonable actual and potential costs to Witte of the Force Majeure and applicable cancellation fees.

Regarding civil unrest, once Witte has investigated the prevailing situation, as it deems fit, it shall remain in Witte's sole and absolute discretion whether to proceed with the trip. You may in such circumstances cancel the trip subject to Witte's and each supplier's terms and conditions.

In case of insufficient participation, geopolitical, or natural cause, or other circumstances beyond its control to the extent travel services cannot be provided wholly or partially, Witte may cancel the tour. In such cases, Witte will use its best efforts to supply alternative services and accommodations, and no refunds will be granted provided that the alternatives are comparable to the original services and accommodations included in the tour cost. In the event of cancellation of the tour by Witte, its liability will be limited to a refund in full of all monies paid by the participants. If available, Witte will offer an alternative trip, which the participants may accept or reject.

California Passengers: Witte is registered as a California Seller of Travel CST# 201-3304-40. Witte is a fully accredited tour operator with the Airlines Reporting Corporation, the International Airlines Travel Agency Network, and is a member of the National Tour Association, the mark of excellence in the group tour industry.

Assumption of Risks/Safety. Travel to certain destinations may involve greater risk than others. Witte urges all participants to remain informed daily as to current news events, as well as to review travel prohibitions, warnings, announcements, and advisories issued by the U.S. Government prior to booking travel to international destinations. Information on conditions in various countries and the level of risk associated with travel to particular international destinations may be found at <http://www.state.gov>, <https://travel.state.gov/content/travel/en/traveladvisories/traveladvisories.html>, <http://www.tsa.gov>, <http://www.dot.gov>, <http://www.faa.gov>, <http://www.cdc.gov>, and <https://www.cbp.gov/travel>

In recognition of the inherent risk of travel and related activities in which you are intending to engage, you confirm that you are physically and mentally capable of participating in the travel booked and that you willingly and voluntarily assume full responsibility for any injury, loss, or damage suffered by you or caused by you. By registering for any related travel activities, you certify that you do not have any mental, physical, or other condition or disability that would create a hazard for yourself or other participants.

The Smart Traveler Enrollment Program (STEP) is a free service provided by the U.S. Government to U.S. citizens who are traveling to or living in, a foreign country. STEP allows you to enter information about your upcoming trip abroad so that the Department of State can better assist you in an emergency. Registration is recommended and provided by going to <https://step.state.gov/step/>

BY OFFERING FOR SALE TRAVEL TO PARTICULAR DESTINATIONS, WITTE DOES NOT REPRESENT OR WARRANT THAT TRAVEL TO SUCH POINTS IS ADVISABLE OR WITHOUT RISK, AND SHALL NOT BE LIABLE FOR COSTS, DAMAGES, OR LOSSES THAT MAY RESULT FROM TRAVEL TO SUCH DESTINATIONS. EACH TRAVELER'S PARTICIPATION CONSTITUTES ACCEPTANCE OF SUCH EVENTS AT THE PARTICIPANT'S OWN RISK.

Traveler acknowledges that Witte Tours or its associates may receive advice from health authorities regarding the trip which may include requirements for the wearing of masks/coverings, guidance in hand hygiene, and avoiding physical contact.

An inherent risk of exposure to communicable disease exists in any public place where people are present. Diseases can be extremely contagious and lead to severe illness and death. According to the Centers for Disease Control and Prevention, senior citizens and guests with underlying medical conditions are especially vulnerable. By traveling on this tour, you voluntarily assume all risks related to exposure to illness and agree to indemnify and hold Witte Tours harmless from third-party claims and any damages due to sickness or death.

Photographs/Videos Copyright Policy, Release, and Authorization. Witte reserves the right to use any photographs/videos taken at any event or during the operation of any travel activity and to use the resulting photography, videos or recordings for promotional or commercial use without the express written permission of those included in the photograph/video. By making a reservation with Witte, the parent/guardian/participant agrees to allow and authorizes his/her likeness to be used by Witte without compensation to the parent/guardian/participant, or anyone else, and releases any claims and demands ensuing from or in connection with the use of the photographs, including any expectation of confidentiality and all claims for libel and invasion of privacy.

Copyright in all photographs, video, and related materials created by participants related to Witte belong to the parent/guardian/participant upon creation. The parent/guardian/participant grants to Witte ("Witte Tour Materials") a nonexclusive, worldwide, irrevocable license to use any Witte Tour Materials provided, sent or available to Witte and/or the organizing academic institution or affiliation group or group participants (including tags) in any media now existing or subsequently developed for the following limited purposes: brochures, invitations, websites, blogs, social media, newspapers, magazines, television, on line marketing, and promotion and advertising of Witte's travel services and programs.

If the parent/guardian/participant prefers their likeness not be used, he/she must notify groups@wittetravel.com in writing prior to departure of the trip and include a photograph.

SECURITY. Any passwords used for registration on this site are for individual use only. You may not share your password with anyone. You are solely responsible for the security of your password and any use of the services by anyone else with whom you share your password. We may monitor your password and, at our discretion, require you to change it. If you use a password that we consider insecure, we may require it to be changed or we may end your account.

If you become involved in any violation of system security, we reserve the right to release your details to system administrators at other sites in order to assist them in resolving security incidents. We reserve the right to investigate all suspected violations of these Terms and Conditions.

We reserve the right to fully cooperate with any law enforcement authorities or court order requesting disclosure of the identity of anyone posting any E-mail messages, or publishing or otherwise making available any materials that are believed to violate these Terms and Conditions. BY ACCEPTING THIS AGREEMENT, YOU WAIVE AND HOLD HARMLESS WITTE FROM ANY CLAIMS RESULTING FROM ANY ACTION TAKEN BY WITTE DURING OR AS A RESULT OF ITS INVESTIGATIONS AND/OR FROM ANY ACTIONS TAKEN AS A CONSEQUENCE OF INVESTIGATIONS BY EITHER WITTE OR LAW ENFORCEMENT AUTHORITIES.

Arbitration: Any controversy or claim arising out of or relating to this Agreement of the performance thereunder, including without limitation any claim related to bodily injury, property damage or death, shall be settled by binding arbitration in Kentwood, Michigan, U.S., in accordance with the rules of the American Arbitration Association then existing, and judgment in the arbitration award may be entered in any court having jurisdiction over the subject matter of the controversy. Such proceedings will be governed by substantive Michigan law. This agreement to arbitrate does not waive or modify the limitation of liability contained in this document.

Exclusive Governing Law and Jurisdiction: This Agreement shall be governed by the laws of the State of Michigan, without regard to conflicts of laws principles. If the right to seek arbitration is for any reason waived by both parties, or if judicial review of any arbitration is sought, any action or legal proceeding arising out of this Agreement shall be brought exclusively in the courts of Kent County, Michigan, and the parties hereby waive any objection to venue or jurisdiction in connection therewith. In connection with any action or legal proceeding arising out of this Agreement, the parties hereby specifically and knowingly waive any rights that either party might have to demand a jury trial. Use of the Witte website is unauthorized in any jurisdiction that does not give effect to all provisions of these terms and conditions, including, without limitation, this paragraph.

Copyright 2017 to Present All Rights Reserved, Witte Associates, Inc.

If you have any questions or concerns, please feel free to email our customer service department at groups@wittetravel.com



3250 28th St SE, Grand Rapids, MI 49512
616.957.8113 | witte-tours.com

052124BRAT_TERMS